



Antenna Mounting Instructions

FILM-NB-GPS

INSTALLATION USING FILM ANTENNA MOUNTED ON GLASS:

1. Use alcohol swipe to clean dirt and dust particles from glass surface.
2. Install with glass above 65° F. so film does not appear cloudy.
3. Mount on glass between 1/8" - 1/4" (4-6mm) thick.
4. Refer to Figure 1 - Antenna Placement
5. When choosing placement, leave room to attach amplifier.

Note: Film antenna must be kept at least 2" away from metal. Orientation of antenna is not critical.

6. Remove adhesive backing from film using pull-tabs. Avoid getting fingerprints on adhesive.

OPTIMUM POSITIONS ARE 1, 2 & 3.

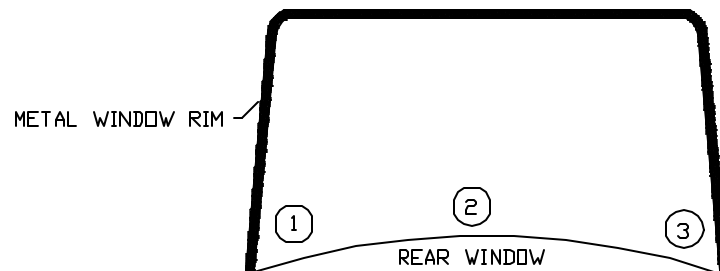
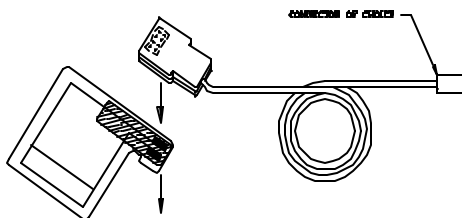

Figure 1 – Antenna Placement

7. After adhering film to glass, press out any air bubbles.
8. Remove top film protecting the antenna contact points.
9. Peel backing tape from amplifier using pull-tabs.
10. Line up amplifier terminal points with the points on the film. (Figure 2)
11. Apply pressure for 20-30 seconds. Adhesive cures in 5-10 minutes.

Figure 2 – GPS Film Antenna



INSTALLATION USING DURABLE RE-USABLE PLASTIC CARD:

1. Remove protective film from plastic card before attaching antenna.



2. Use figure 3 as a transparent template for correct antenna placement on plastic card.
3. Remove adhesive backing from film using pull-tabs. *Avoid getting fingerprints on adhesive.*

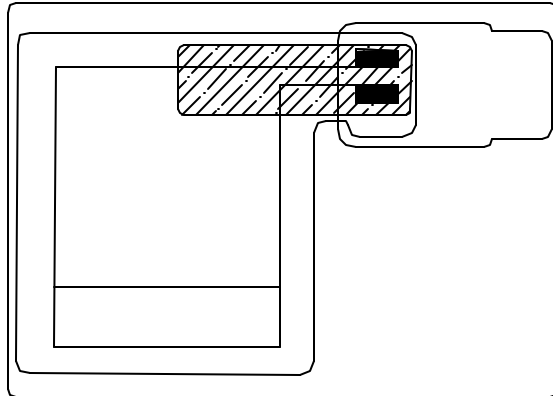

Figure 3 - GPS Film Antenna Template

4. After adhering film to card, press out any air bubbles.
 5. Remove top film protecting the antenna contact points.
 6. Peel backing tape from amplifier using pull-tabs.
 7. Line up amplifier terminal points with points on the film (Figure 4).
 8. Apply pressure for 20-30 seconds. *Adhesive cures in 5-10 minutes.*
 9. Use with or without adhesives. (not supplied) for temporary mounting.
- Antenna is not weather resistant.*

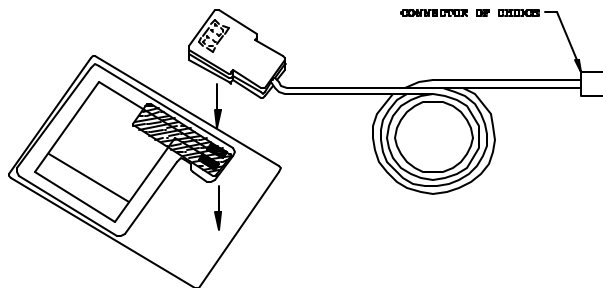

Figure 4 Plastic Card Installation